

TECHNICAL BULLETIN

INFORMATION ONLY

For the Attention of : Installers, Testers, Trade Customers, Training Dept,

Date : 23/03/09

Product : System 21 Passenger Lifts

Subject : Changes to Mirror Trim Details

Status : Product Update - Information only

Pages : 1

Originator : Stannah Lifts Ltd, Anton Mill, Andover, Hants SP10 2NX 01264 339090

Detail

The fixing holes on all mirror trims have been replaced with a vertical slot to enable the top trim to be pulled down for a closer fit on the mirror. This feature has been introduced for traction lifts where the mirror can jump if the safety gear engages in the upward direction. The mirror trims should now be fitted as follows:

Fit the upper trim with the screws positioned at the bottom of the slot. The screws should then be fastened while leaving them just loose enough to allow the trim to be pulled down when the mirror is fitted.

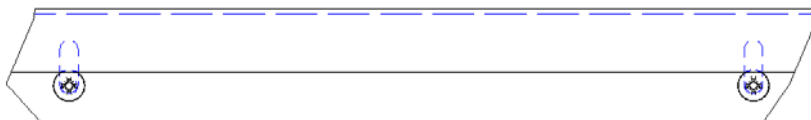

Fit the lower trim containing the packers with the screws positioned at the top of the slot and fasten the screws.

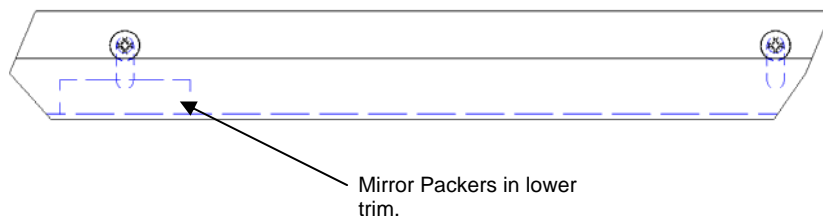

The mirror may now be fitted and the top trim pulled down.

This change affects all passenger lifts manufactured from 16/03/09.